

## Getting Started With your New iPad

Plug in your iPad charger at the base of the device, leave it plugged in until charged. While it is charging you can begin the setup process.

First, you will need to select your region, it should be on United States, if not choose that.

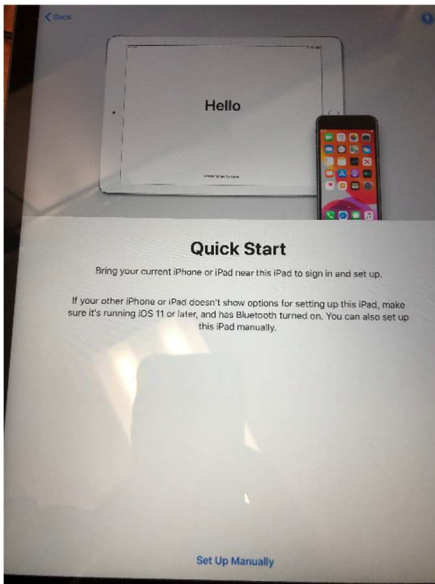

You should see the quick start page. Choose Setup Manually at the bottom.

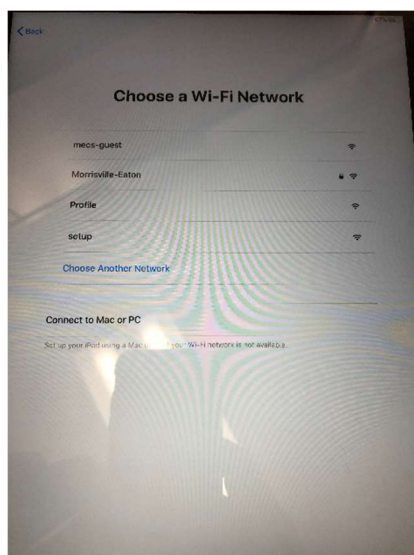

Connect to your Wi-Fi network, it should be listed, touch it and enter your password if needed.



You will be prompted to allow remote management, click next at the top.

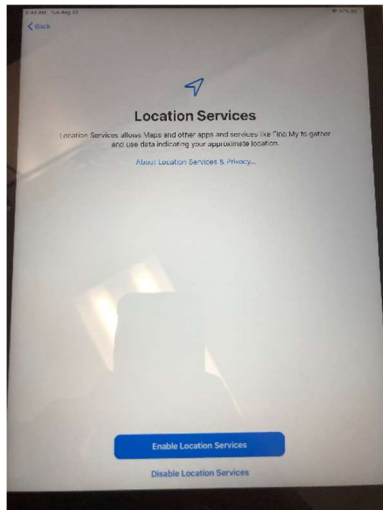

On the location service screen, click enable.

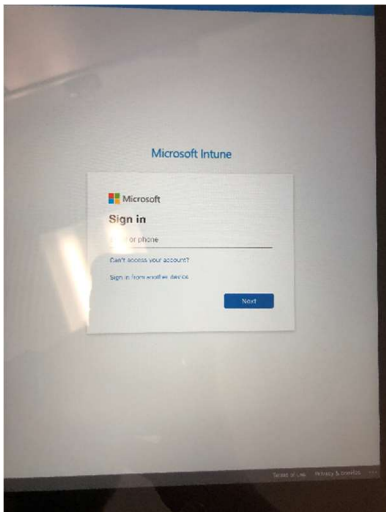

You will need to sign into the device to complete setup.

For elementary students, the passwords are set to the first three characters of their username. Usernames are the last two digits of graduating year, first initial and last name, followed by @m-ecs.org. For example, a third grader named John Doe, their username would be [30jdoe@m-ecs.org](mailto:30jdoe@m-ecs.org) and their password would be 30j.

Click next through any additional prompts and you should be all set.

If you need assistance, please submit a ticket by emailing [tickets@m-ecs.org](mailto:tickets@m-ecs.org) or if you are unable to get online, call 315-684-5900.